

TRUMA SPARES

C6002

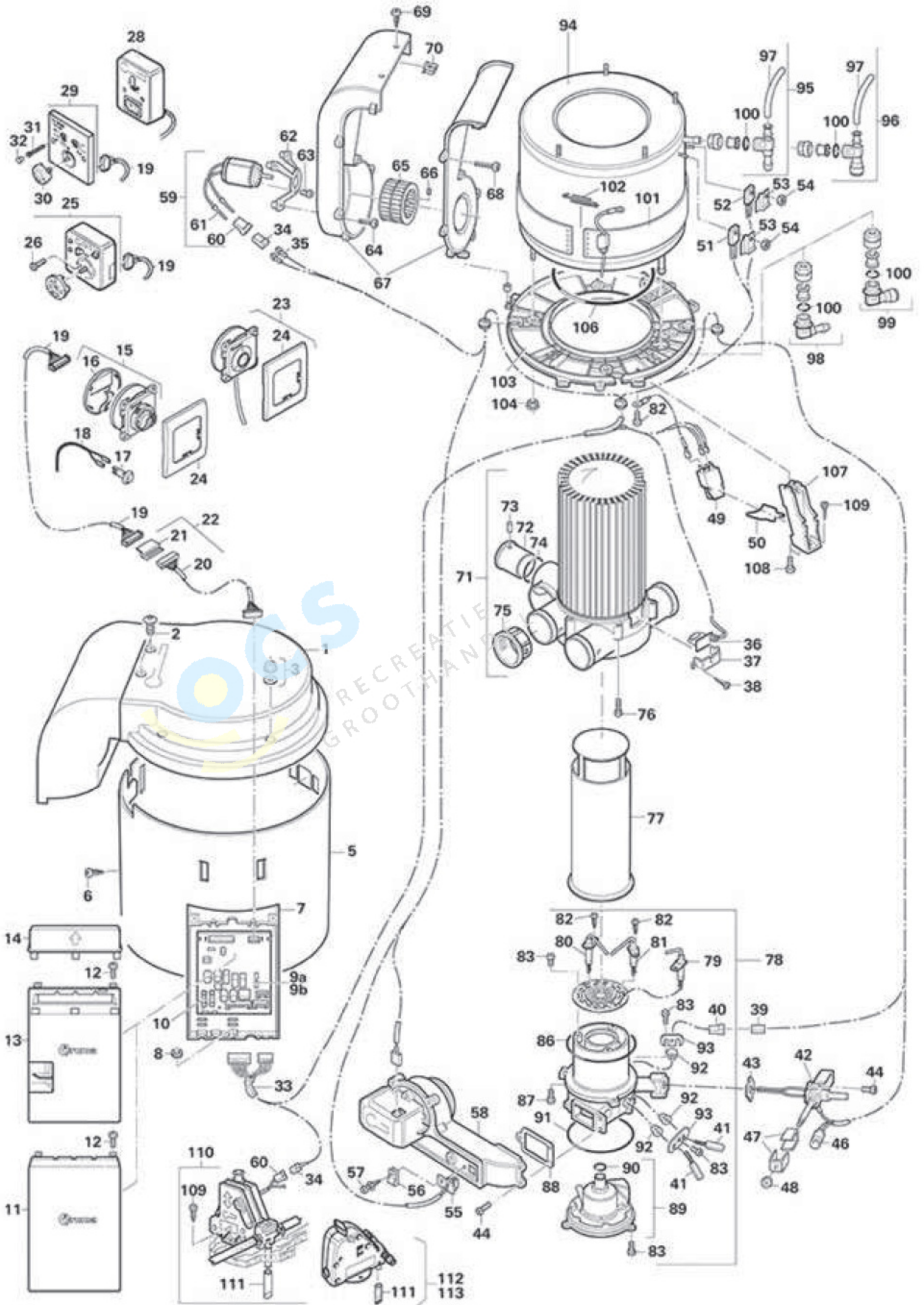

TRUMA SPARES

No.	Truma No.	Description		
001	34010-08000	Case cover	056	34000-57400
002	34000-50600	Seal	057	10010-89000
003	34010-16000	Screw / nut set (4x)	058	34000-55000
005	34000-43500	Casing	059	34000-77300
006	10010-64600	Screw B 3.5 x 13		34000-70500
007	34000-06100	Electronic housing	060	34000-31600
008	34000-51900	Starlock washer	061	34000-33800
009	34000-98300	Exchange-Electronic C 6002 D, E >12200001 < 16300000	062	34000-04400
	34000-77100	Exchange-Electronic C 6002 < 12200000	063	10010-13600
	00000-00001	N/A Electronic	064	10010-51100
	34000-98100	Electronic C 6002 D, E > 16300001	065	34000-04700
	34000-98200	Exchange-Electronic C 6002 D, E > 16300001	066	10020-41000
	34010-07100	Electronic C 6002 EH > 17100001	067	34010-08100
010	34000-76800	Fuse 6.3A >12200001	068	10010-40600
	34000-33100	Fuse 4A <12200000	069	10010-91200
011	34000-06200	Housing lid < 04/02	070	39010-55400
012	30050-13000	Screw KB 30 x 8	071	34000-82500
013	34000-91100	Housing lid > 05/02	072	34000-02700
014	34000-91200	Connect'n cover >05/02	073	10020-41400
015	34000-59000	Control panel Trum'tic C	074	34010-05700
016	34000-60500	Housing cover grey	075	34000-06900
	34030-29900	Housing cover black	076	10010-51200
017	34000-69700	Room temp. sensor > 05/02	077	34000-52700
018	34000-71900	Cable 4 m > 05/02	078	34000-85000
019	34000-09300	Cable for con. panel 3 m	079	34000-76500
020	34000-09400	Cable for con. panel 5 m	080	34000-76300
021	34000-09800	Coupling for cable	081	34000-76400
022	34300-01	Extension cable 5 m	082	10010-70000
023	34000-63800	Control panel Trumatic C EL with 3 m cable	083	10010-83300
024	34000-67700	Cover frame black	086	10030-27000
	34000-60600	Cover frame grey	087	10010-51000
025	00000-00011	N/A	088	34000-05600
026	10010-78900	Screw B 2.9 x 25	089	00000-00001
028	70000-01600	Control panel 230 V 2.5 m < 04/02	090	10030-23600
029	30030-98500	Control panel combi(UK)	091	10030-26900
030	00000-01100	Control knob UK	092	34000-57100
031	00000-01000	Screw M 3.5 x 25 UK	093	34000-57200
032	00000-11100	Screw cover UK	094	34000-88000
033	34000-71200	Cable harness > 05/02	095	34150-01
034	34000-31700	Spade connector housing 2-pin	096	34151-03
035	34000-33900	Flat connector 2.8 mm	097	34000-17700
036	34000-51300	Thermostat plate	098	70150-01
037	34000-04500	Thermostat holder	099	70151-03
038	10010-82400	Screw CM 3 x 10	100	10030-21600
039	34000-31500	Spade connector housing 1-pin	101	34000-57500
040	34000-03900	Connector housing 1-pin	102	34000-57600
041	34000-50700	Spade connector housing 1-pin	103	34000-41500
042	34000-21400	Solenoid valve C 60/40 30 mbar	104	10020-15100
	34000-20400	Solenoid valve C60 50 mbar	106	34000-03100
043	34000-02300	Gasket	107	34000-01900
044	10010-11500	Screw M 4 x 12	108	10010-51500
046	34000-81000	Solenoid coils low+high	109	10010-66200
047	70000-54600	Set coil holders	110	00000-00001
048	10020-25000	Self-locking nut M 4	111	70000-20200
049	34010-14100	Ignitor 35Hz	112	34020-80200
050	34000-53500	Clip	113	34020-80300
051	34000-34200	Thermostat overtemp		
052	34000-34300	Temp. sensing device		
053	70000-07000	Heat conducting plate		
054	10020-17000	Nut M 3		
055	34000-83500	Thermostat plate		
				comb'n air temperature
				Cable clip
				PT-screw 3 x 10
				Combustion air fan
				D.C. motor 12 V C 60/40 D > 12200001
				D.C. motor 12 V C 3402 6002 < 12200000
				Connector housing 2-pin
				Spade connector 2.8
				Motor bracket
				Screw M 4 x 6
				Screw MM 5 x 12
				Fan wheel - air
				Threaded bolt AM 4 x 4
				Fan housing complete
				PT-screw WN 1452
				Screw C 4.2 x 13 torx
				Sheet nut 4.2
				Heat exchanger C
				Sleeve
				Dowel pin 2.5 x 12
				O-ring 40 x 2.5
				Reducer VR-ÜR
				Screw M 5 x 16
				Flame tube
				Burner comp. (40, 79-93)
				Flame rectific'n electrode
				Spark electrode left
				Spark electrode right
				Screw B 2.9 x 6.5 torx
				Screw M 4 x 10, Torx
				O-ring 110 x 2
				Screw M 5 x 16
				Gasket
				N/A Burner cover comp.
				O-ring 16 x 3.5
				O-ring 90 x 3
				Leadtrough
				Clamp sheet
				Water container
				Elbow fitting 2 flex
				Elbow fitting 2 J.G.
				Condensation tube 8 x 1.5 (900 mm long)
				Elbow fitting TB flex
				Elbow fitting J.G.
				O-ring 10 x 25
				Heating collar 230 V
				Retaining spring
				Floor plate
				Nut M 5 with washer
				Round cord seal 203 x 4
				Foot
				Screw DM 5 x 20
				Screw B 5.5 x 25
				N/A safety/drain valve
				Drain tube 110 mm long
				FrostControl 2.8bar flex
				FrostControl 2,8 bar JG